

# U channel profiles

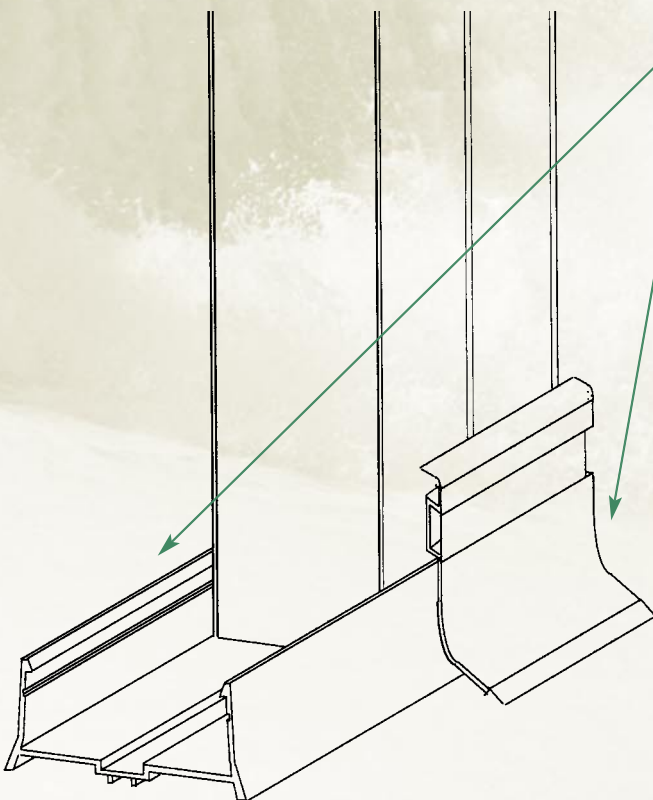
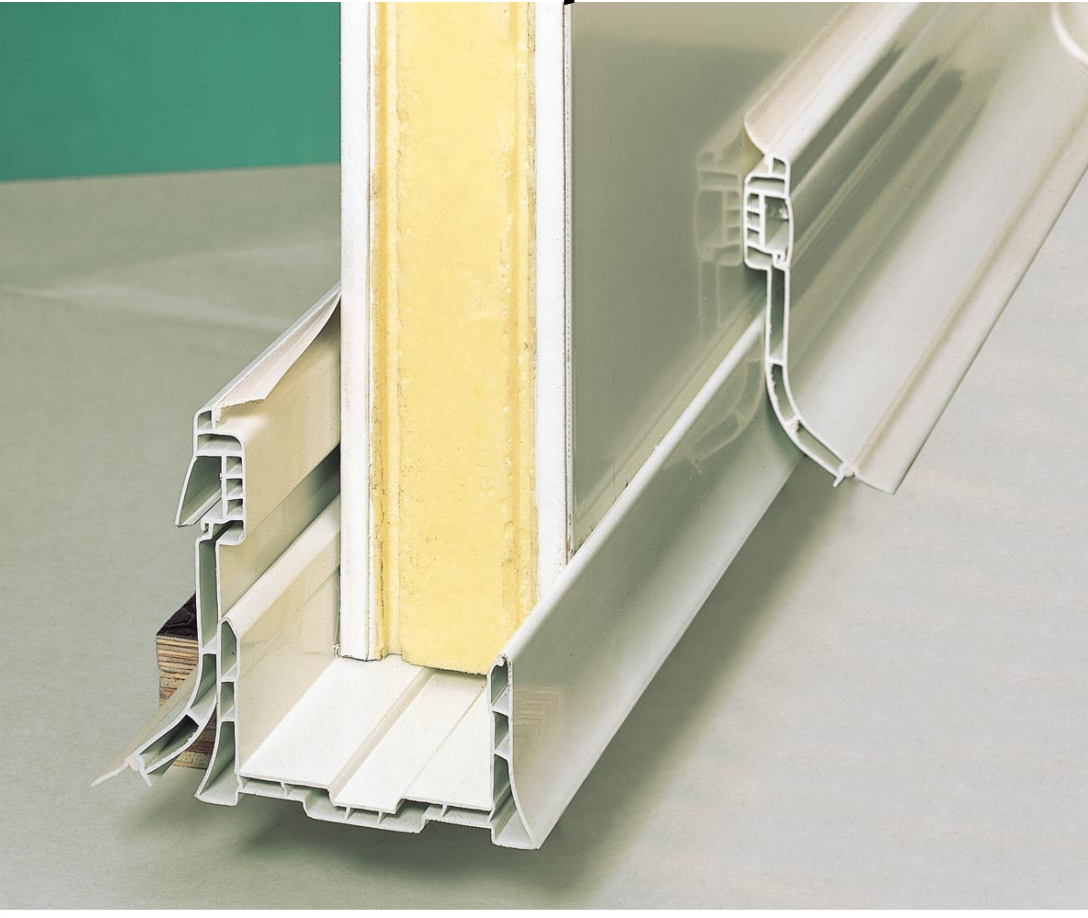

## MASTIC OPTION

The edge detail of the 'U' channel allows the joint to be finished with a sealant if this is required.

## SKIRTINGS / PLINTH PROFILES

'U' channels are designed with a profiled finish to allow them to be used on their own, or in conjunction with **Skirtings: EX15/EX80** plinth profiles

## STANDARD COLOURS

'U' channels are available in standard colours of:  
white ral 9002 • white ral 9010

Rigid PVC section



# U channel profiles

- **EX.04** Rigid PVC 'U' profile with rounded edge detail. For 60 mm panels.  
Offered in 3 metre lengths.  
Minimum order unit = 102 metres (34 lengths).
- **EX.49** Rigid PVC 'U' profile with rounded edge detail. For 75 mm panels.  
Offered in 3 metre lengths.  
Minimum order unit = 102 metres (34 lengths).
- **EX.05** Rigid PVC 'U' profile with rounded edge detail. For 80 mm panels.  
Offered in 3 metre lengths.  
Minimum order unit = 102 metres (34 lengths).
- **EX.06** Rigid PVC 'U' profile with rounded edge detail. For 100 mm panels.  
Offered in 3 metre lengths.  
Minimum order unit = 102 metres (34 lengths).
- **EX.23** Rigid PVC 'U' profile with rounded edge detail. For 120 mm panels.  
Offered in 3 metre lengths.  
Minimum order unit = 102 metres (34 lengths).
- **INJ.81** PVC connection profile for 60mm 'U' profile EX.04  
Minimum order unit: 4 pieces each.
- **INJ.248** PVC connection profile for 80mm 'U' profile EX.05  
Minimum order unit: 4 pieces each.
- **INJ.49** End cap for 'U' profiles  
Offered in boxes of 10 pieces each (5 right / 5 left)

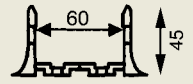

EX.04

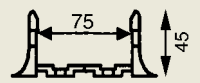

EX.49

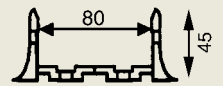

EX.05

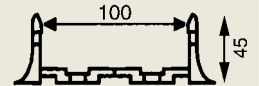

EX.06

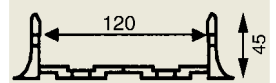

EX.23

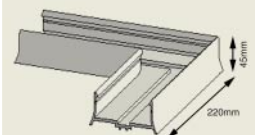

INJ.81 • INJ.248

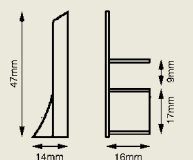

INJ.49

# Asymmetric U channel profiles

## FOR INDUSTRIAL APPLICATIONS

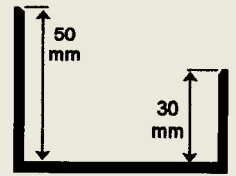
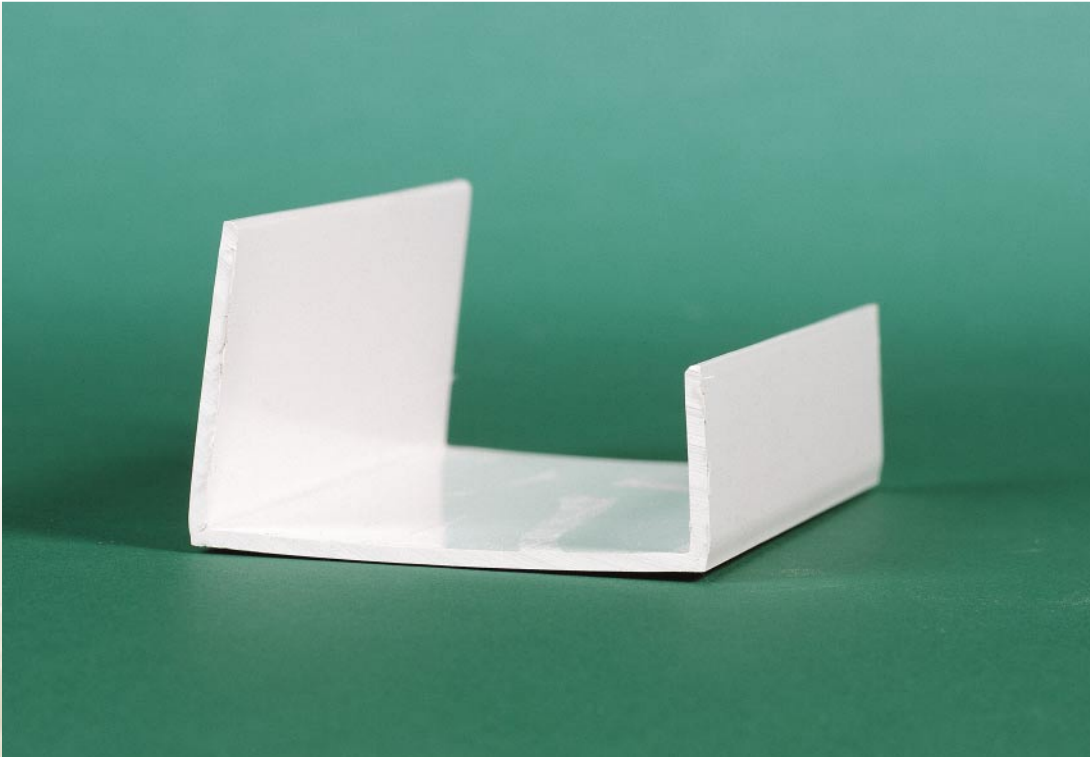

EX.68 • 50mm  
(+ 1,5mm)

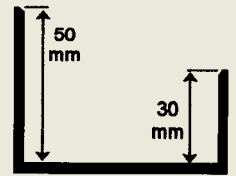

EX.64 • 60mm  
(+ 1,5mm)

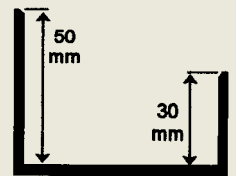

EX.65 • 75mm  
(+ 1,5mm)

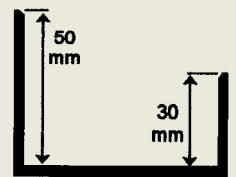

EX.66 • 80mm  
(+ 1,5mm)

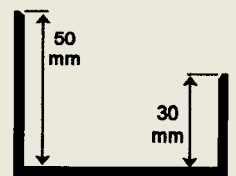

EX.67 • 100mm  
(+ 1,5mm)



### THE ASYMETRIC U-CHANNEL IS VERY CONVENIENT TO USE :

You slide the panel by the small side of the U till it touches the bigger back side. Then you “rotate” the panel upright.

The Asymmetric U profile resists very well to impacts and is UV-stabilized

# U channel profiles

## FOR INDUSTRIAL APPLICATIONS

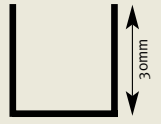
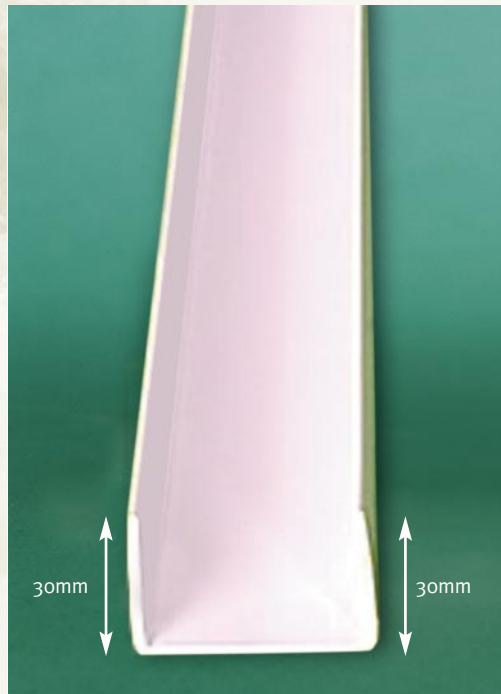
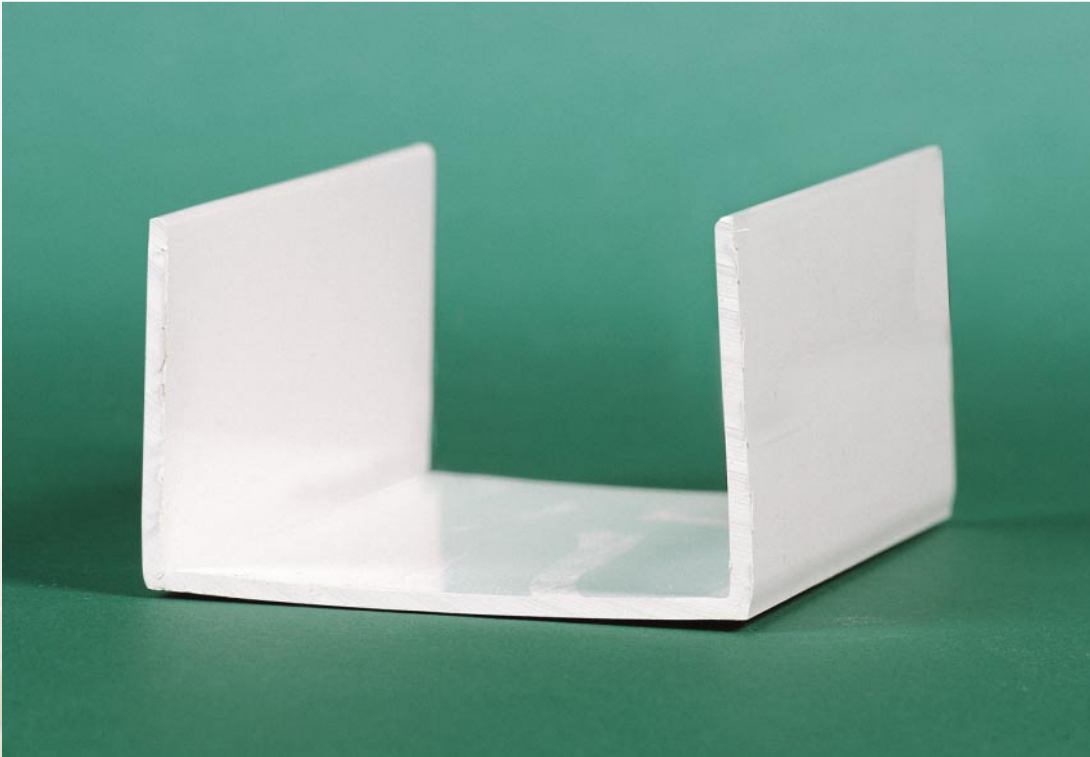

EX.101 • 30mm (+ 1,5mm)

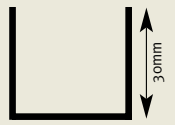

EX.102 • 40mm (+ 1,5mm)



EX.103 • 50mm (+ 1,5mm)



EX.104 • 60mm (+ 1,5mm)



EX.105 • 75mm (+ 2mm)



EX.106 • 80mm (+ 2mm)



EX.107 • 100mm (+ 2mm)



EX.108 • 125mm (+ 2mm)

- U-profiles are **UV stabilized**
- Standard colour: white
- Other lengths, dimensions and colours: available on request
- **High Impact resistance**
- Ideal for door frame finishing or industrial panel installation